

## 钴高速钢套式端面铣刀

**PRECITOOL**  
PRÄZISIONSWERKZEUGE

	<b>P</b> N/mm <sup>2</sup>	<b>M</b> N/mm <sup>2</sup>	<b>K</b> HB	<b>S</b> N/mm <sup>2</sup>
155200	<1200	<750	<240	Hastelloy B
155400				
vc = m/min.				
155200	16-32	10-12	22-25	8-10
155400				

技术说明:  
横向槽和纵向槽符合 DIN 138

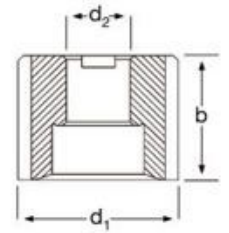

155200



155400

**155200** PRECITOOL, 钴高速钢, HR型  
**155400** PRECITOOL, 钴高速钢, HR型, TiAlN涂层

$d_1(\text{js16}) \times b \times d_2$ mm	<b>155200</b> (RG 1500)	<b>155400</b> (RG 1500)	Z	fz mm/齿
40×32×16	●	●	8	0,050-0,055
50×36×22	●	●	8	0,050-0,055
63×40×27	●	●	10	0,060-0,066
80×45×27	●	●	10	0,070-0,077

## 钴高速钢套式端面铣刀

**PRECITOOL**  
PRÄZISIONSWERKZEUGE

	<b>P</b> N/mm <sup>2</sup>	<b>M</b> N/mm <sup>2</sup>	<b>K</b> HB
155500	<850	<750	<240
155501			
vc = m/min.			
155500	18-37	10-12	17-25
155501			

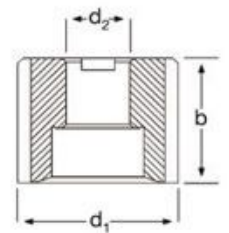

155500



155501

**155500** PRECITOOL, 钴高速钢, NF型  
**155501** PRECITOOL, 钴高速钢, NF型, TiAlN涂层

$d_1(\text{js16}) \times b \times d_2$ mm	<b>155500</b> (RG 1500)	<b>155501</b> (RG 1500)	Z	fz mm/齿
40×32×16	●	○	6	0,080-0,088
50×36×22	●	○	6	0,085-0,094
63×40×27	●	○	8	0,100-0,110
80×45×27	●	○	8	0,110-0,120
100×50×32	●	○	10	0,110-0,120